

CREVE COEUR ICE ARENA – LOCKER ROOM REOPENING PLAN

The following layout of the ice rink shows the plan to reopen the locker rooms and adjust the flow to better separate the players who are coming and going for scheduled ice times. Anyone using the locker rooms would need to use the temporary exit at the West end of the ice rink to avoid going back into the lobby.

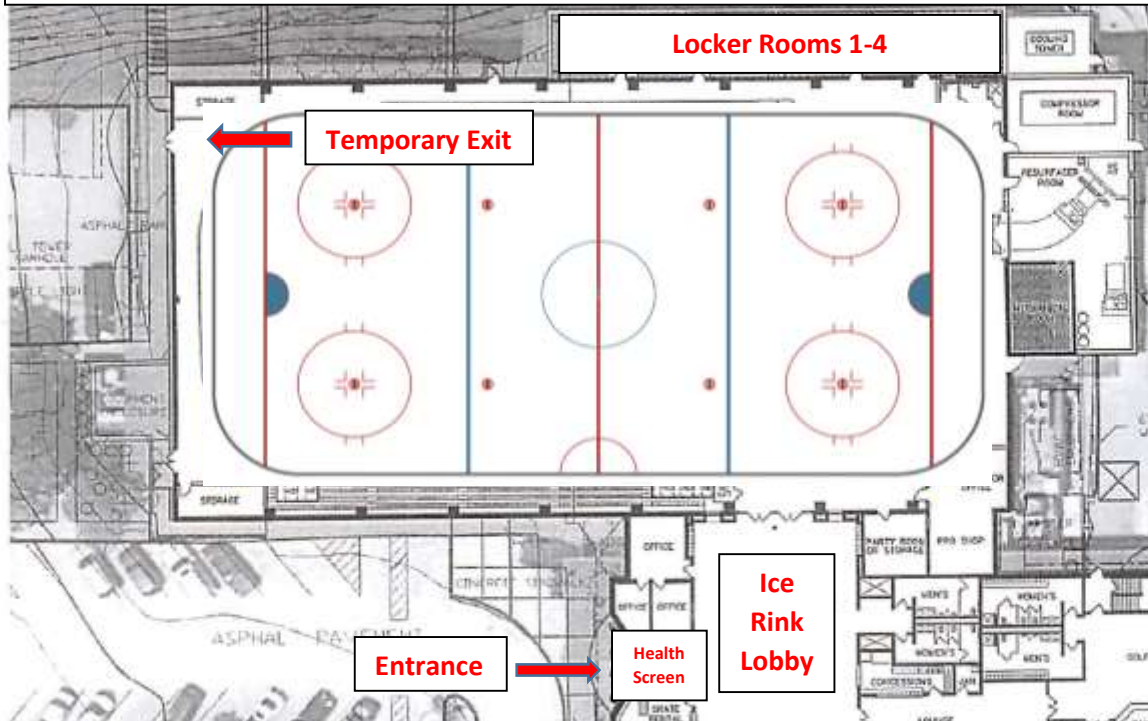

LOCKER ROOM

The following must be followed if you are using the locker room:

- Max 10 players.
- Masks must be worn at all times.
- 6-Foot Social distancing is required.
- Door must be propped open at all times.
- Restroom/shower must remain locked.
- Come as dressed as you can. Use the lobby restroom for anything less than a t-shirt and shorts.
- Arrive 15 minutes before your ice time.
- Exit 15 minutes after your ice time.
- Exit through the new temporary exit at the end of the ice rink, past the player's benches. Follow the arrows.

This plan is in place with the approval of St. Louis County and the City of Creve Coeur. If not followed, players will be asked to leave and teams will lose their contracted ice time for the future...we are in this together!

Plan is to use all four locker rooms and with the posted guidelines to the right. Please review the guidelines and share with your team, especially the one regarding... Come as dressed as you can. Use the lobby restroom for anything less than a t-shirt and shorts.

Staff will let the teams know if they are using the lobby or the locker rooms. Staff will continue to review the new procedure and adjust if necessary.

Health screens must still take place upon entering the building, even if you are using the locker rooms.