

Squirt Olympic's Locker Room Assignments

Dear Parents, Coaches, and Team Managers. The Squirt Olympics will be a packed house and will require your cooperation to be a fun event for all involved.

1. **Absolutely no hockey bags due to limited space.** We recommend using a backpack or skate bag for your shoes & trading pins. Please get dressed at your hotel or in your car. ****Goalies are the only exception.**
 - a. You will be sharing a locker room with other teams. The locker rooms will be crowded. Please try to limit them to players and coaches.
 - b. Parents should sit in the rink your child has an event on.
 - c. Do not bring your stick unless you are in the Target Shootout or the Goalie Race. We recommend writing your name & cell phone on your stick. You will be placing your stick in the player box on Scheels Arena prior to your event.
2. **6:00PM-** All teams will proceed to the Scheels Rink for a group photo.
 - a. Goalies and Shootout players will immediately put their sticks in the Scheels player box. Please do not take on the ice for photo. Make sure your name and phone # is on them.
 - b. Only kids with Helmets will be allowed on the ice for the group picture.
 - c. **Remain on the ice for an opening video and National Anthem! Players please keep your helmets on during the Anthems.**
 - d. 2 minute skate around. Players must skate in one direction!
3. **6:30PM-** The Puck Relay participants will exit the West end of Scheels and proceed directly onto the Farmers Union Insurance Rink for the Puck Relay.
4. **6:31PM-** The Obstacle Participants will exit the West end of the Scheels rink and proceed to waiting area on the South end of the Farmers Union Insurance Rink.
5. **6:35PM-** The Target Shootout Participants will wait along the boards of SCHEELS Arena and wait until the Goalie Race is completed.
6. **6:36PM-** The Goalie Race Participants will remain on the ice in the Scheels Rink and begin their race.

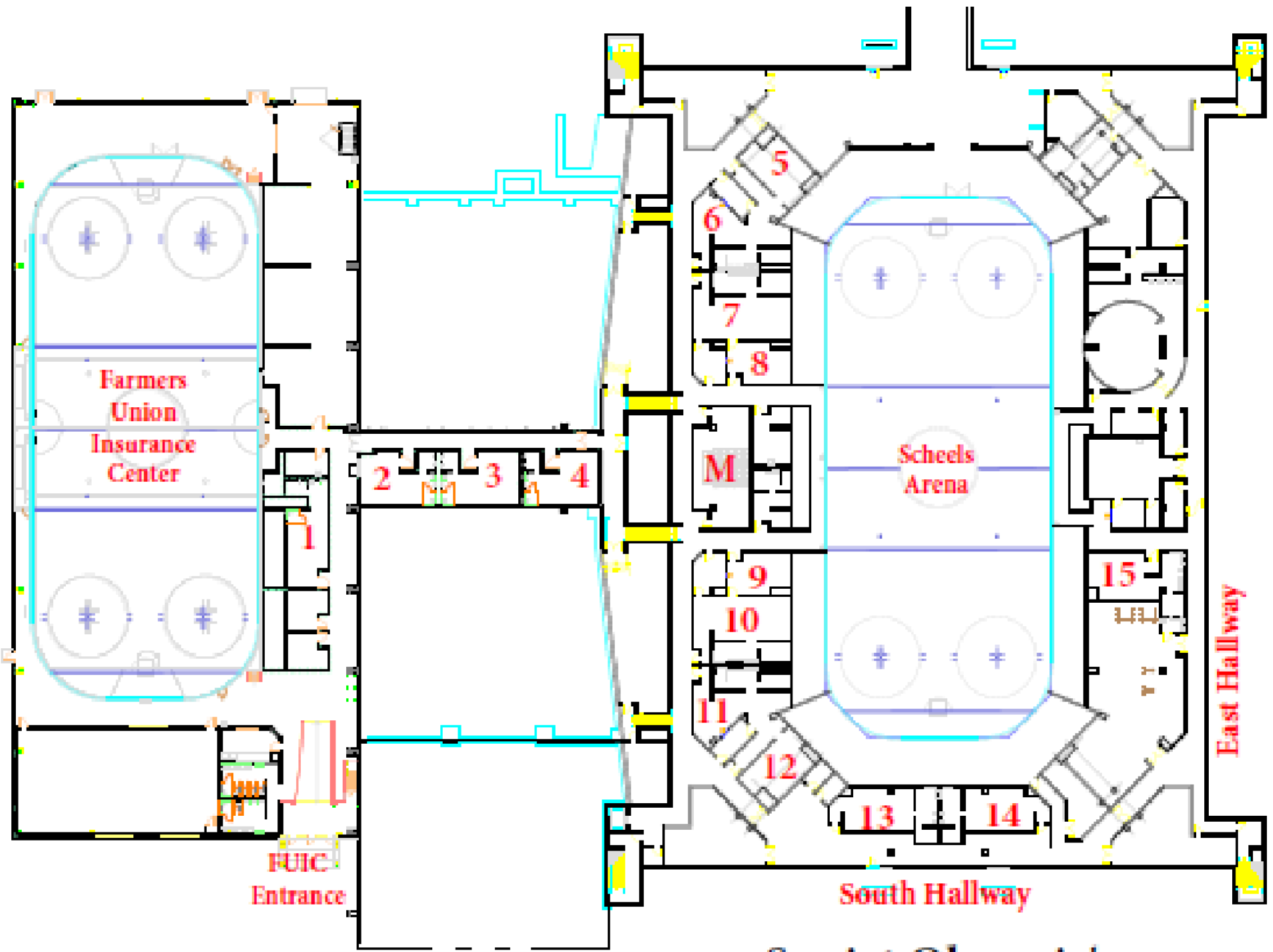

**Scheels
Entrance**

**Squirt Olympic's
Locker Room Assignments**