

Bond Impact on Athletics and Football

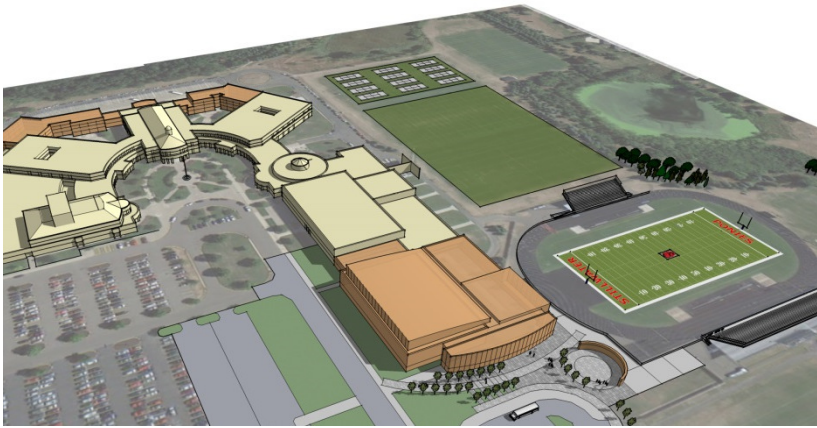

BUILDING THE FUTURE | Bond 2015: Reinvesting in Facilities



Expanding Activity Spaces
for Students and the Community



Curiosity Thrives Here

Current Challenges

For students and staff:

- Lack of classroom and locker room spaces
- Limited use of practice fields and gym spaces
- Inadequate Fitness Center
 - Poor ventilation
 - Under-sized
- Limited teaching stations both inside and outside
- Limited storage facilities

For the community:

- Limited use of fields
 - Pony Stadium only used for varsity events (30/year)
- Not enough gym spaces
 - After 6 p.m. weekdays
 - Limited access weekends
- Inability to host state tournaments, weekend events

Other Challenges

- Physical education and athletics competing for space
 - Wrestling and gymnastics equipment takes up space
- Athletic teams practice later in evening
 - Winter practices are held until 6:30 p.m.
 - Spring practices (indoors) are held until 9:30 p.m. and time is limited to 90 minutes per team
- Spring thaw makes grass fields unusable
- Limited concession area for school and community groups
- Additional costs:
 - Shuttle buses to bring junior high students to high school
 - Porta-Pot rental at Pony Stadium
 - Field maintenance

Proposed High School Addition



Stillwater
AREA PUBLIC SCHOOLS

Curiosity Thrives Here

Proposed Pony Activity Center



PAC Features:

- Four new gym spaces
- Classroom spaces
- Gymnastics area
- Fitness area
- Restrooms and concessions
- Upgraded Pony Stadium entrance
- Multi-purpose fields
- Relocated tennis courts



Stillwater
AREA PUBLIC SCHOOLS

New Opportunities

Expanded activity spaces benefit the community

- Increased fitness opportunities for adults and seniors:
 - Indoor walking track
 - Fitness area
 - Gym spaces and fields
- Ability to host large tournaments, events
 - Brings more people to our communities to shop, dine, stay
- More gyms and fields for youth and adult sports teams
 - Earlier practice times for youth, expanded access for all



Stillwater
AREA PUBLIC SCHOOLS

Curiosity Thrives Here

Impact of Bond on Ponies Football



- Ninth graders at high school
 - We're one of four communities in metro; and one of just two in SEC without freshman
- New weight room, indoor track, gyms
 - Increase in size and function of weight room
 - Indoor track for warm-up, running, plyometrics, and more
- Pony Stadium and practice fields
 - Synthetic turf surface
 - Permanent concessions, ticket booths, and bathrooms in expansion
 - Increased opportunities at Pony Stadium

Synthetic Turf Surface

SEC schools with synthetic surface

- East Ridge – 2009
- Mounds View – 2004
- Park – 2007
- Roseville – 2008
- Woodbury – 2008
- CDH (UST) – 2005 & on site practice field
- White Bear Lake – 2015
- ***And 54 other Minnesota high schools!***

**Stillwater
and Forest
Lake are only
schools
without turf**



Stillwater

AREA PUBLIC SCHOOLS

Curiosity Thrives Here

Benefits of Turf

- Better performance with limited recovery time and maintenance
- Expanded use of Pony Stadium
 - Annually, just 30 events are held on grass at Pony Stadium
- Extended use of fields in Minnesota fall and spring
- Ability to host more events, MSHSL events, and tournaments, which benefits local business
- We are behind the times. It is not a luxury, it has become the norm



Stillwater
AREA PUBLIC SCHOOLS

Curiosity Thrives Here

May 1, 2014 at Pony Stadium



Summary

- Bond would provide an opportunity to improve the quality of education for our students
- It also gives us a chance to meet the needs of our entire community



Stillwater

AREA PUBLIC SCHOOLS

Curiosity Thrives Here



ISD 834 - Outstanding Debt

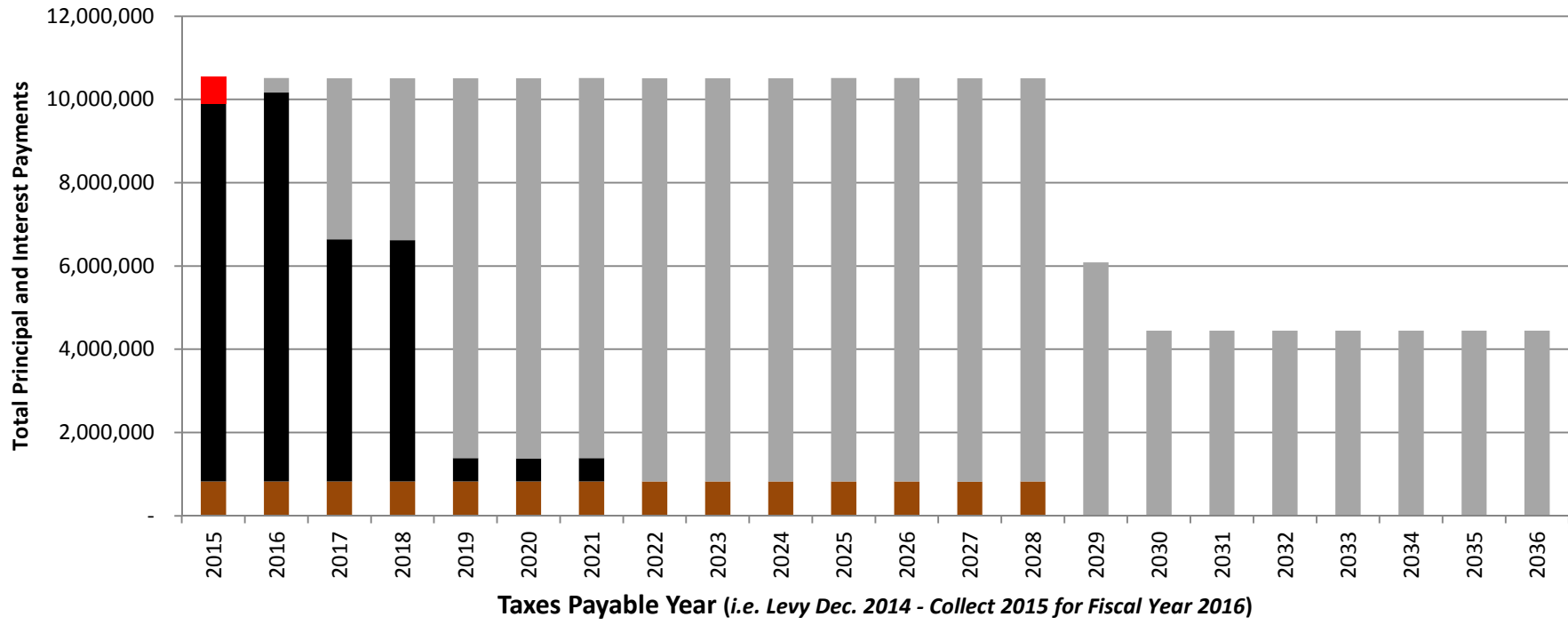

■ Certificates of Participation, Series 2011A
■ Valley Crossing School Payment

■ General Obligation Bond Total Debt (not including Capital Facilities)
■ New Voter Approved Debt Payments



Stillwater
 AREA PUBLIC SCHOOLS

Curiosity Thrives Here

Sample Ballot

**SCHOOL DISTRICT QUESTION 1
APPROVAL OF SCHOOL DISTRICT BOND ISSUE**



YES



NO

Shall the school board of Independent School District No. 834 (Stillwater Area Public Schools) be authorized to issue its general obligation school building bonds in an amount not to exceed \$97,500,000 to provide funds for the acquisition and betterment of school sites and facilities, including the construction and equipping of a classroom addition and various other improvements to the Stillwater High School site and facility to allow that facility to serve grades 9 to 12 and the construction of an activity center at that site; the acquisition of land for and the construction and equipping of an elementary school facility and a transportation terminal; the construction of upgrades and improvements to the Pony Stadium and various other athletic sites and facilities; and the acquisition and installation of HVAC systems and various other improvements to existing elementary school sites and facilities?

**BY VOTING "YES" ON THIS BALLOT QUESTION, YOU
ARE VOTING FOR A PROPERTY TAX INCREASE.**



**Minnesota state law
requires ballot
to include
Voting "YES"
disclaimer regardless
of if a bond
referendum is causing
an annual increase
in property taxes**



Stillwater

AREA PUBLIC SCHOOLS

Curiosity Thrives Here

Taxpayer is being asked to forgo:

- 1) \$98.66 reduction with taxes payable in 2017
- 2) \$146.45 reduction with taxes payable in 2019

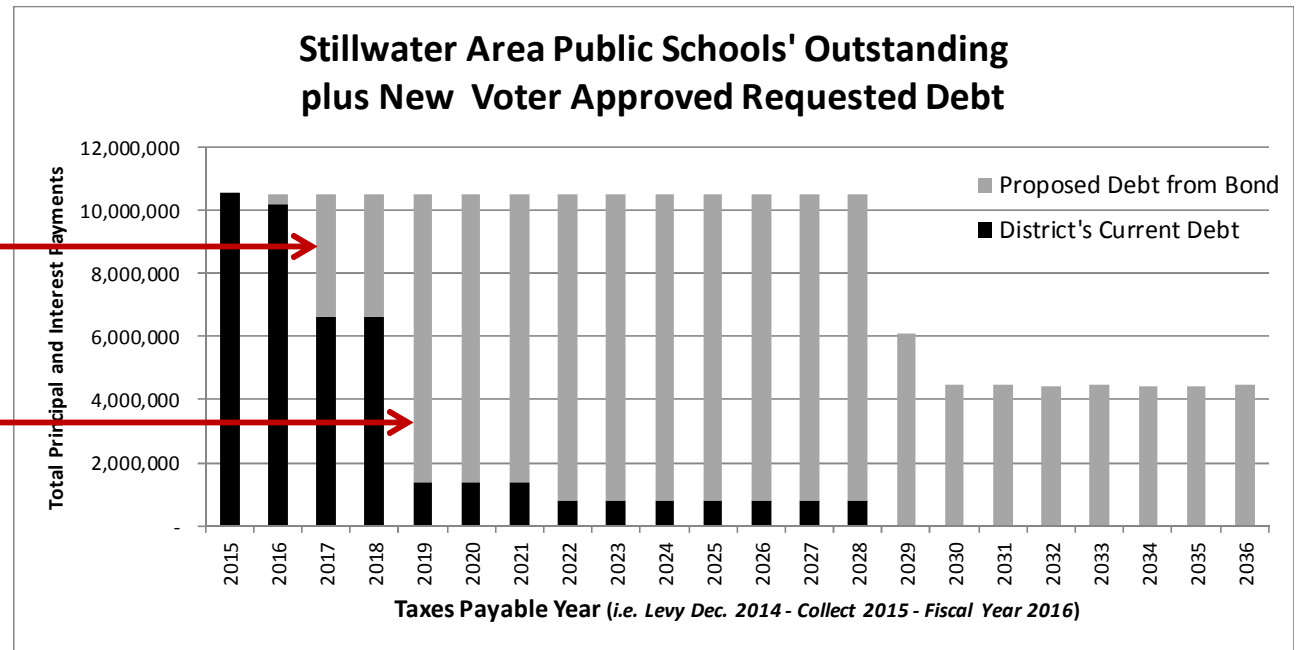

Assumes a \$250,000 homestead residential property



Stillwater
AREA PUBLIC SCHOOLS

Curiosity Thrives Here

Action Required!

- Go and vote on May 12th!
- Talk with your friends and neighbors
- Talk with your teammates in the Stillwater Public School district
- Talk with your parents if they still live in the Stillwater Public School district